



**716-STUB-14**

Quarter Wave Surge Arrestor 7-16 DIN male / female bulkhead, 690 to 2700 MHz

Surge arrestors are designed to protect wireless base stations, switching centers and transmission lines from the damaging effects of extreme high voltage surges caused by lightning strikes. The RFS Technologies lightning protection devices are designed and tested to the most demanding specifications. They are rated to protect against both direct and indirect multiple strikes in the harshest environments imaginable. Their rugged construction utilizes solid metal housing, and superior plating, which results in outstanding system protection and operating continuity.

**FEATURES / BENEFITS**

- Superior IM performance for reliable long-term operation
- Excellent electrical performance, low VSWR, low insertion loss
- Waterproof to IP68
- Totally maintenance free
- Compliant to RoHS (EU 2002/95/EC) and CRoHS (China SJ/T11363-2006) i.e. usable on a global basis.



716-STUB-14

**External Document Links**

[Installation Instruction](#)

**Notes**

incl. screw M8x12, spring washer 8 mm and washer 8 mm for installation of grounding cables or bus bars

**Technical features**

**STRUCTURE**

<b>Product Line</b>		Coaxial Cable Components
<b>Product Type</b>		Surge Arrestor
<b>Surge Arrestor Type</b>		Quarter Wave
<b>Design</b>		90° Stub
<b>Coaxial Cable Type</b>		Foam Dielectric, Ultraflexible Foam Dielectric, Radiating Cable
<b>Connector Interface</b>		7-16 DIN

**MECHANICAL SPECIFICATIONS**

<b>Configuration</b>		7-16 DIN male - 7-16 DIN female (bulkhead)
<b>Connector A</b>		7-16 DIN Male
<b>Center Contact Connector A</b>		Brass, silver plated
<b>Outer Contact Connector A</b>		Brass, Tri metal
<b>Connector B</b>		7-16 DIN Female bulkhead (protected)
<b>Center Contact Connector B</b>		Brass, silver plated
<b>Outer Contact Connector B</b>		Brass, Tri metal
<b>Body</b>		Brass, Tri metal
<b>Dielectric</b>		PTFE
<b>Gasket</b>		Silicone
<b>Sealing class</b>		IP68
<b>Mounting / Grounding</b>		Bulkhead; Thread for grounding M8
<b>Drill Hole Size</b>	mm (in)	M8



### 716-STUB-14

Quarter Wave Surge Arrestor 7-16 DIN male / female bulkhead, 690 to 2700 MHz

#### ELECTRICAL SPECIFICATIONS

Frequency Range - MHz		690 - 2700
VSWR, Return Loss	VSWR (dB)	690-2700 MHz: 1.19 (21) 800-1000 MHz: 1.13 (24) 1700-2200 MHz: 1.13 (24)
Insertion Loss, dB (Max)	dB	0.10
3rd Order IM Product @ 2x20 Watts	dBc	< -160
Surge current handling capability		mult. 25kA, Pulse 8/20 $\mu$ s
Residual pulse		5mj typically (test pulse 20 kA Pulse 8/20 $\mu$ s)
Residual Voltage		100V (test pulse 20 kA Pulse 8/20 $\mu$ s)
Average Power		1.8kW @ 1 GHz (at 20°C, sea level, VSWR 1.0)
Peak Power	kW	40kW (at 20°C, sea level, VSWR 1.0)

#### TEMPERATURE SPECIFICATIONS

Operation Temperature	°C (°F)	-45 to 85 (-49 to 185)
-----------------------	---------	------------------------

#### ACCESSORIES

Spare Part / Useful Accessories		GW-16/20 : Grounding Wire Kit
---------------------------------	--	-------------------------------

#### PACKAGING INFORMATION

Package Quantity		1
------------------	--	---

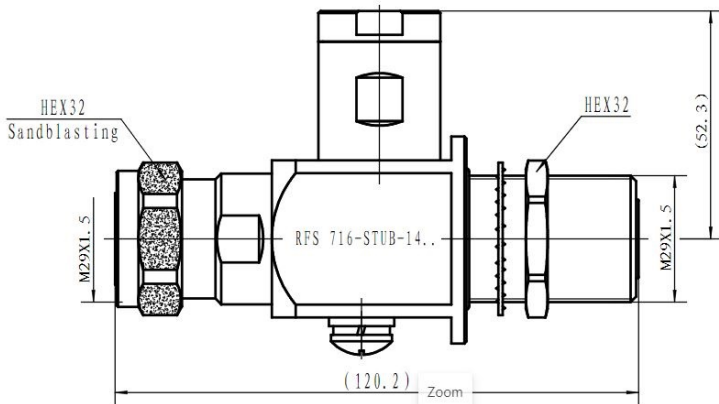

Outline drawing, dimension in millimeters