



OMNI FIT™ high performance connectors are designed for use with both CELLFLEX® (copper) and CELLFLEX® Lite (aluminium) cables. They are designed specifically to provide the highest quality connector-cable interface while simplifying and speeding up connector attachment. All RFS Technologies connectors are fully tested for mechanical and electrical compliance to industry specifications. The N connector meets all technical requirements and covers high frequencies as well as legacy applications. Sealing against outer conductor and jacket by means of o-ring and 360° compression fit.



**FEATURES / BENEFITS**

- Ultra high PIM performance i.e. reduced interference leading to high customer satisfaction
- Two-piece design i.e. visual inspection of interlocking leads to improved installation security
- OMNI FIT™ concept i.e. streamlined order management and reduced stock level
- Watertight sealing in mated and unmated condition, i.e. reduced efforts during installation and improved security during operation
- Tri metal alloy plating i.e. extreme resistance against corrosion even under hardest climatic and environmental circumstances
- Multi-thread (Tristart) design i.e. simplified and accelerated tightening process
- RoHS (EU) and CRoHS (China) compliant i.e. can be used on a global basis

**Technical features**

**GENERAL SPECIFICATIONS**

<b>Transmission Line Type</b>		Coaxial Cable
<b>Cable Size</b>		3/8
<b>Cable Type</b>		Foam Dielectric
<b>Model Series</b>		LCF38-50 Series
<b>Connector Interface</b>		N
<b>Connector Type</b>		OMNI FIT™ PREMIUM Right Angle
<b>Sealing Method</b>		O-ring + 360° Compression
<b>Gender</b>		Male Right Angle

**ELECTRICAL SPECIFICATIONS**

<b>Nominal Impedance, ohms</b>	Ohm	50
<b>3rd Order IM Product @ 2x20 Watts</b>	dBc	-158 ; typical -163
<b>Maximum Frequency</b>	GHz	6
<b>VSWR, Return Loss</b>	VSWR (dB)	0 &lt; f ≤ 1.0 GHz: 1.02 (40) 1.0 &lt; f ≤ 2.2 GHz: 1.04 (34) 2.2 &lt; f ≤ 2.7 GHz: 1.07 (30) 2.7 &lt; f ≤ 3.8 GHz: 1.08 (28) 3.8 &lt; f ≤ 5.0 GHz: 1.15 (23) 5.0 &lt; f ≤ 6.0 GHz: 1.22 (20)



**MECHANICAL SPECIFICATIONS**

<b>Plating Outer/Inner</b>		Tri metal alloy/Silver
<b>Length</b>	mm (in)	70 (2.756)
<b>Outer Diameter</b>	mm (in)	24 (0.945)
<b>Inner Contact Attachment</b>		Basket
<b>Outer Contact Attachment</b>		Spring Finger

**ACCESSORIES**

<b>Wrench size front</b>	mm (in)	22
<b>Wrench size rear</b>	mm (in)	22

**TESTING AND ENVIRONMENTAL**

<b>Waterproof Level</b>		IP68
-------------------------	--	------

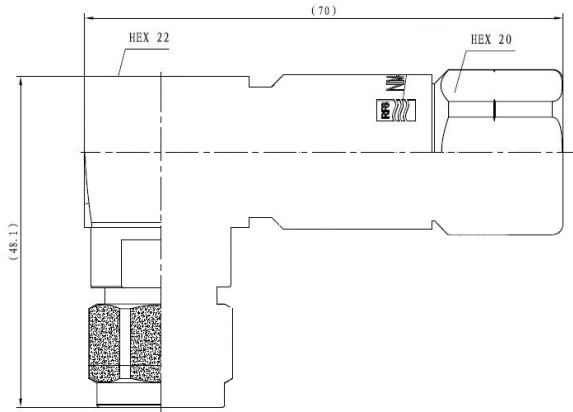

**External Document Links**

[1000028400\\_inst\\_con\\_lcf38-e01.pdf](#)

**Notes**