



The 43-TER Series are coaxial loads which operate from DC up to 3.8 GHz. The products are ideally suited for termination of unused ports in distributed antenna systems or in RADIAFLEX® radiating cables systems.



**FEATURES / BENEFITS**

- Ideal for all kind of DAS applications
- Finned termination for optimized heat dissipation
- Low VSWR

**Technical features**

**GENERAL SPECIFICATIONS**

<b>Product Type</b>		Load
<b>Techn. Application</b>		Indoor

**ELECTRICAL SPECIFICATIONS**

<b>Frequency Range</b>	MHz	DC-3.800
<b>Impedance</b>	Ohm	50
<b>Max. VSWR / Return Loss, dB</b>	VSWR/dB	/19
<b>Total Input Power</b>	W	50

**MECHANICAL SPECIFICATIONS**

<b>Input Connector Type</b>		4.3-10 male
<b>Diameter</b>	mm (in)	75 (2.95)
<b>Length</b>	mm (in)	140 (5.51)

**TEMPERATURE SPECIFICATIONS**

<b>Temperature Range</b>	°C (°F)	-25 to 65 (-13 to 149)
<b>Environmental Class</b>		Indoor

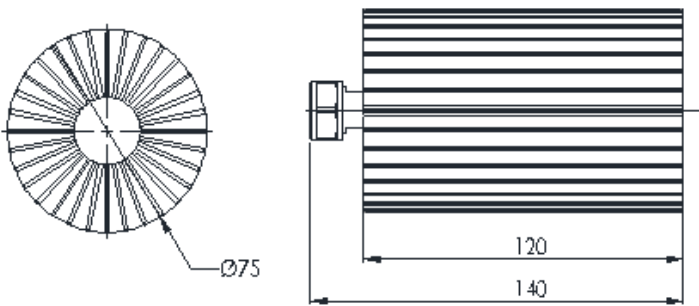

**External Document Links**

**Notes**

Derated power rating by -1.5%/°C above 50°C